

kHz RANGE CRYSTAL UNIT CYLINDER

C - TYPE C - 2 - TYPE / C - 4 - TYPE

- Frequency range : 32.768 kHz (20 kHz to 307.2 kHz)
- Thickness : $\phi 1.2$ mm to $\phi 3.1$ mm
- Overtone order : Fundamental / Overtone(192 kHz,307.2 kHz)
- Applications : Clock and Microcomputer



C-001R C-002RX C-004R C-005R
C-2-TYPE C-4-TYPE

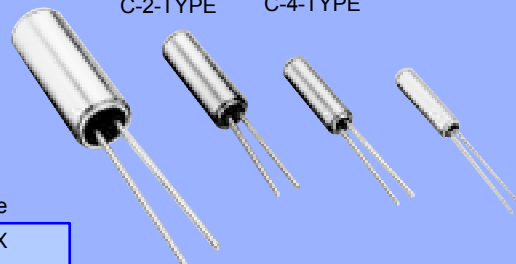

Actual size

C-002RX



Specifications for C-TYPE (characteristics)

Item	Symbol	C-001R	C-002RX	C-004R	C-005R	Remarks
Nominal frequency range	f	32.768 kHz				
Temperature range	T _{stg}	-20 °C to +70 °C				Store as bare product after unpacking
Storage temperature range	T _{use}	-10 °C to +60 °C				
Level of drive	DL	1.0 μ W Max.				
Frequency tolerance (standard)	f _{tol}	$\pm 20 \times 10^{-6} + 2$				5 °C, DL=0.1 μ W
Turnover temperature	T _i	+25 °C ± 5 °C				
Parabolic coefficient	B	$-0.04 \times 10^{-6} / ^\circ\text{C}^2$ Max.				
Load capacitance	CL	6 pF to ∞ P				lease specify
Motional resistance (ESR)	R ₁	35 k Ω Max. (18 k Ω Typ.)	50 or 60 k Ω Max. (30 k Ω Typ.)	50 k Ω Max. (30 k Ω Typ.)	50 k Ω Max. (37 k Ω Typ.)	
Motional capacitance	C ₁	2.1 fF Typ.	2.0 fF	2.0 fF	1.9 fF Typ.	
Shunt capacitance	C ₀	0.9 pF Typ.	0.85 pF	0.85 pF	0.75 pF Typ.	
Frequency aging	f _{age}	$\pm 3 \times 10^{-6} / \text{year}$ Max.				+25 °C, First year

Specifications for C-2-TYPE C-4-TYPE (characteristics)

Item	Symbol	Specifications		Remarks
		C-2-TYPE	C-4-TYPE	
Nominal frequency range	f	20 kHz to 165 kHz, 307.2 kHz	32 kHz to 120 kHz, 192 kHz	
Temperature range	T _{stg}	-20 °C to +70 °C		Store as bare product after unpacking
Storage temperature range	T _{use}	-10 °C to +60 °C		
Level of drive	DL	1.0 μ W Max.		
Frequency tolerance (standard)	f _{tol}	$\pm 20 \times 10^{-6}, \pm 50 \times 10^{-6}, \pm 100 \times 10^{-6}$ (307.2 kHz: $\pm 100 \times 10^{-6}$)	$\pm 50 \times 10^{-6}, \pm 100 \times 10^{-6} + 2$	5 °C, DL=0.1 μ W
Turnover temperature	T _i	+25 °C ± 5 °C		
Parabolic coefficient	B	$-0.04 \times 10^{-6} / ^\circ\text{C}^2$ Max.		
Load capacitance	CL	6 pF to ∞ P		lease specify
Motional resistance (ESR)	R ₁ 55	k Ω to 6 k Ω 55	∞ P to 10 k Ω	As per below table
Motional capacitance	C ₁	4.0 fF to 0.6 fF		
Shunt capacitance	C ₀	2.0 pF to 0.6 pF		
Frequency aging	f _{age}	$\pm 5 \times 10^{-6} / \text{year}$ Max.		+25 °C, First year

Motional resistance C - 2 - TYPE

Frequency	20 kHz \leq f < 31.2 kHz	31.2 kHz \leq f < 40 kHz	40 kHz \leq f < 90 kHz	90 kHz \leq f < 130 kHz	130 kHz \leq f < 165 kHz	307.2 kHz
Motional resistance	55 k Ω Max.	35 k Ω Max.	20 k Ω Max.	12 k Ω Max.	10 k Ω Max.	6 k Ω Max.

Motional resistance C - 4 - TYPE

Frequency	32 kHz \leq f < 38 kHz	38 kHz \leq f < 60 kHz	60 kHz \leq f < 74 kHz	74 kHz \leq f < 100 kHz	100 kHz \leq f < 120 kHz	192 kHz
Motional resistance	55 k Ω Max.	30 k Ω Max.	25 k Ω Max.	22 k Ω Max.	15 k Ω Max.	10 k Ω Max.

External dimensions

(Unit:mm)

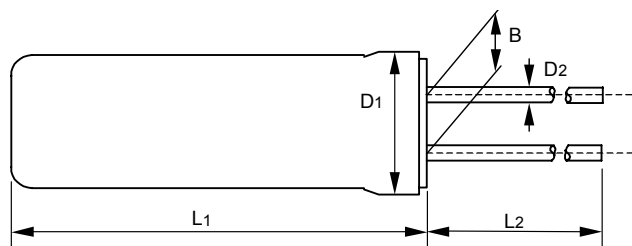

Model	L1	L2	D1	D2	B
C-001R 8.0	Max.	9.0 Min.	$\phi 3.1$ Max.	$\phi 0.3$	1.1
C-002RX C-2-TYPE	6.0 Max.	4.0 Min.	$\phi 2.0$ Max.	$\phi 0.2$	0.7
C-004R C-4-TYPE	5.0 Max.	4.0 Min.	$\phi 1.5$ Max.	$\phi 0.18$	0.5
C-005R 4.6	Max.	4.0 Min.	$\phi 1.2$ Max.	$\phi 0.15$	0.3

160 kHz to 165 kHz, 307.2 kHz: D1 = $\phi 2.2$ Max.